

LOC		DIST		REVISIONS			
P	LTN	DESCRIPTION	DATE	DWN	APVD		
A		RELEASED PER ECO 15-010930	8-18-15	CT	PD		

- MATERIAL:
 BODY: ALUMINUM PER ASTM B317
 INSERT: BRASS PER ASTM B36
- FINISH:
 BODY: .000600 MIN MATTE TIN PER ASTM B545
 OVER .000060 MIN NICKEL PER ASTM B733.
 INSERT: .000150 MIN MATTE NICKEL PER QQ-N-290
- PTFE DRY LUBRICANT 360 DEGREE ON OUTER DIAMETER OF CRIMP BARREL IN ZONE SHOWN.

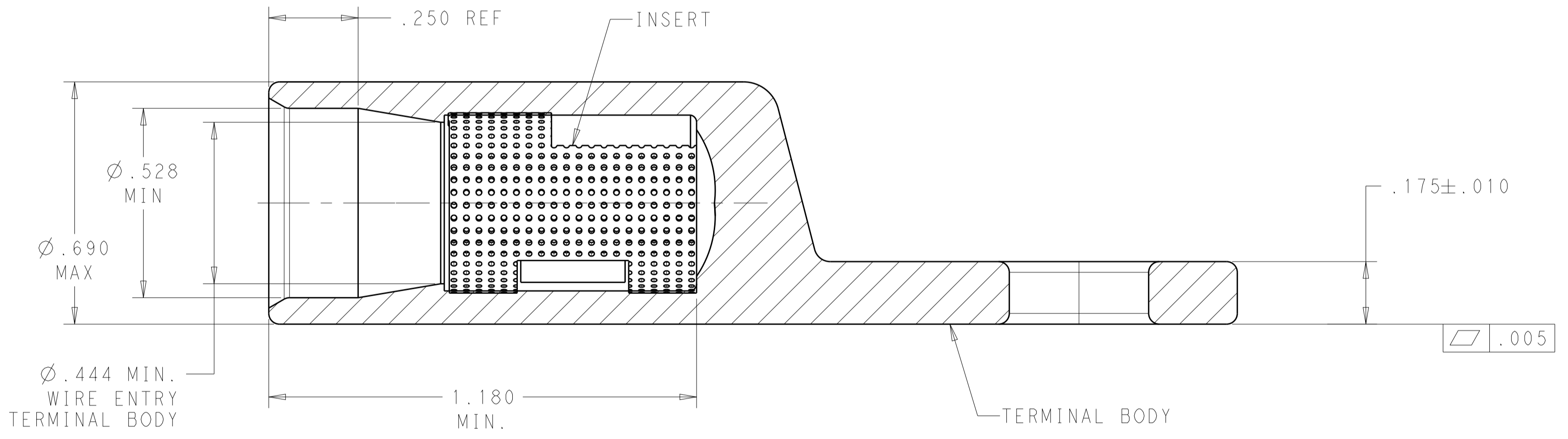
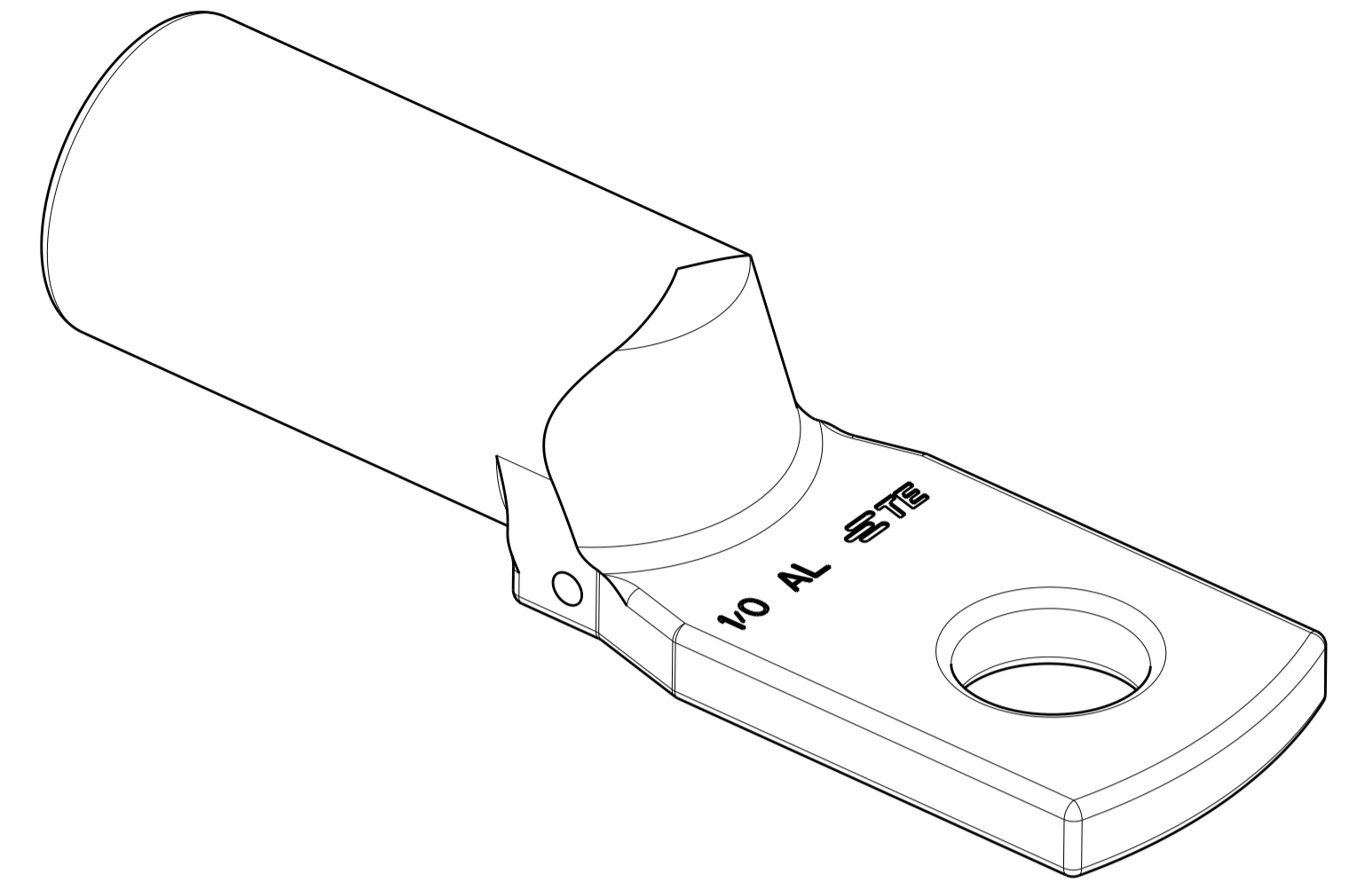
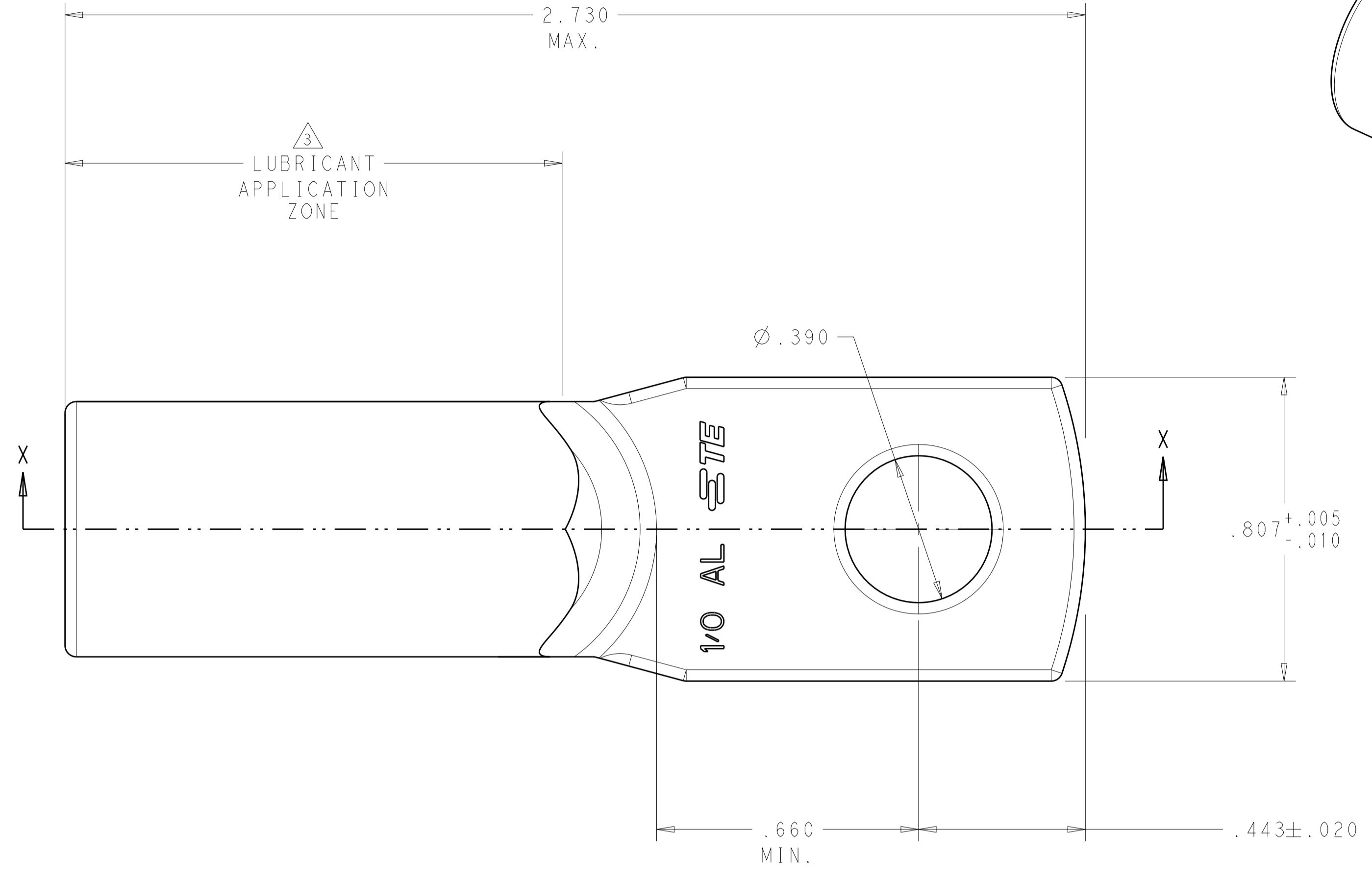

SECTION X-X

2102572-1
 PART NUMBER

THIS DRAWING IS A CONTROLLED DOCUMENT.		DWN D. FABIAN 14NOV2011	TE Connectivity
DIMENSIONS: IN		CHK DEROCK, KIM 28NOV2012	
TOLERANCES UNLESS OTHERWISE SPECIFIED:		APVD DEROCK, KIM 28NOV2012	NAME ASSEMBLY, ALUMINUM TERMINAL, STRAIGHT, SINGLE HOLE, 170
0 PLC ±.1	1 PLC ±.01	PRODUCT SPEC	APPLICATION SPEC
2 PLC ±.005	3 PLC ±.0005	SIZE	CAGE CODE DRAWING NO
4 PLC ±.0005	ANGLES ±.1°	RESTRICTED TO	
MATERIAL SEE CALL-OUT	FINISH SEE CALL-OUT	WEIGHT 21.22GRAMS	A100779 ©=2102572
Customer Drawing		SCALE 4:1	SHEET 1 OF 1 REV A