

# Minty Synth

## Quick Start Guide

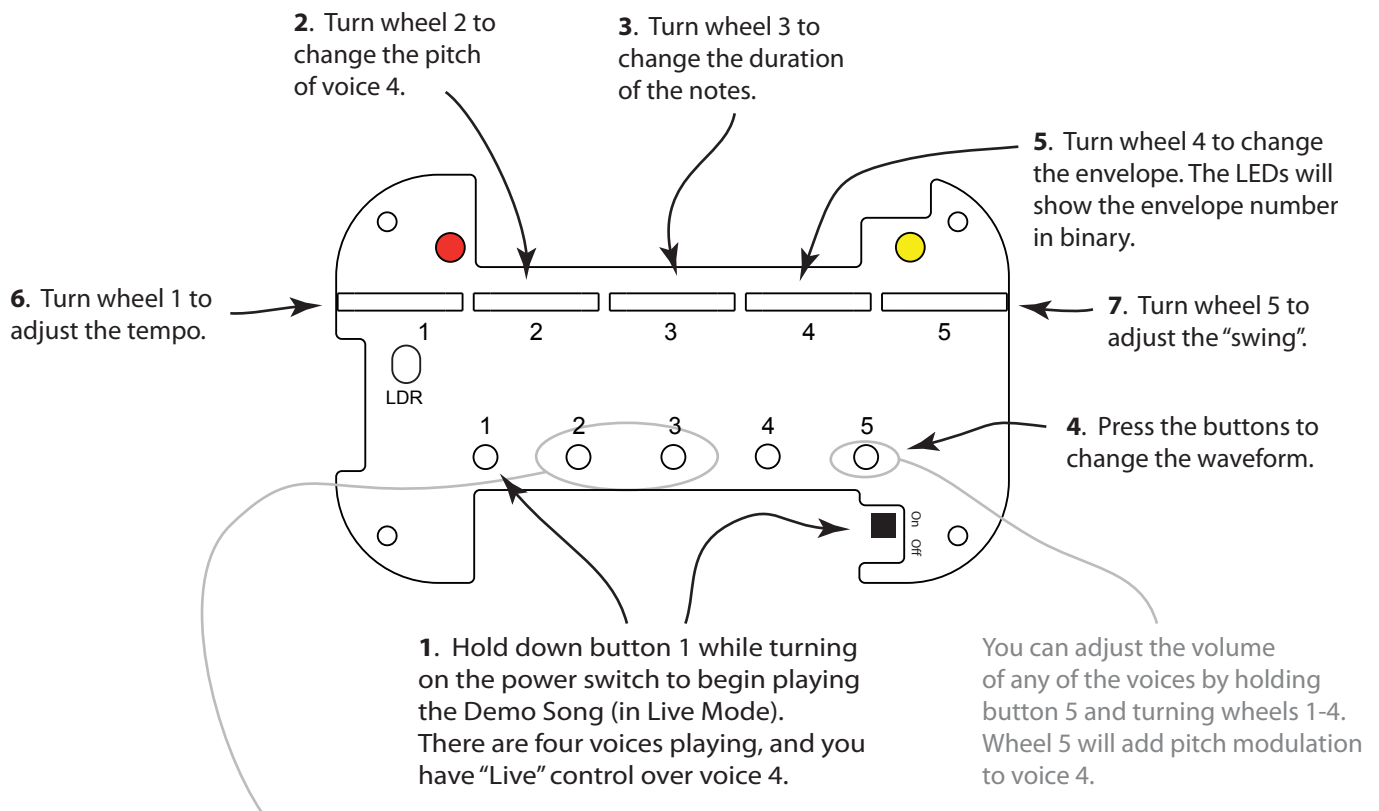

Press buttons 2 and 3 to transfer pitch control to the photocell (LDR). Try not to block the photocell while you do this, because it will be calibrated to the ambient light level. Now you can move your hand over the photocell or open and close the lid to change the pitch of voice 4. To recalibrate the photocell to a different light level you can press buttons 2 and 3 again. If you turn wheel 2 it will take pitch control back from the photocell.

You can reprogram buttons 1-4 to different waveforms by holding down on one of the buttons and turning wheel 1. After a few seconds you will hear samples of the 15 available waveforms as you turn the wheel. Releasing the button will program it to the currently selected waveform (it will be reset when you turn off the device).

Please see the software manual at [mintysynth.com](http://mintysynth.com) for creating your own songs and many more features.