

VIEW A

CENTERLINE OF PIN IN AREA SHOWN NOT TO VARY FROM CENTERLINE OF PIN AT DATUM -D- BY MORE THAN .008 IN ANY DIRECTION

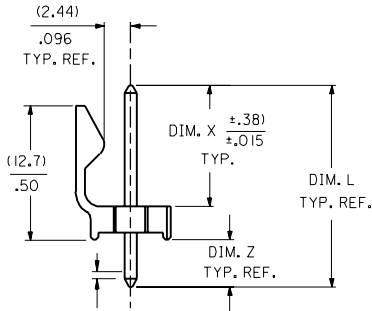

CENTERLINE OF PIN IN AREA SHOWN NOT TO VARY FROM CENTERLINE OF PIN AT DATUM -D- BY MORE THAN .005 IN ANY DIRECTION

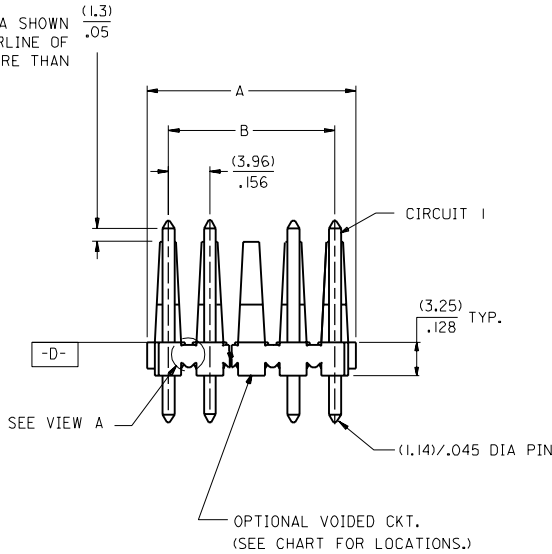

- NOTES:
- PRECEDING ENG. NO. IN CHART DESIGNATES STANDARD PRODUCT.
 - SOLDERABILITY: WHEN PARTS ARE SOLDERED AT A TEMPERATURE OF (230°C) OR 446°F FOR 5 SECONDS EACH SOLDERED SURFACE SHALL BE A MINIMUM OF 95% COVERED WITH A SMOOTH CONTINUOUS ADHERENT COATING. FOR OTHER INFORMATION SEE SMES-152
 - PIN PUSH OUT FORCE: PRIOR TO SOLDERING, A 3 LB MINIMUM FORCE (IN EITHER DIRECTION) SHALL BE REQUIRED TO PUSH THE PIN OUT OF THE HEADER.
 - MATERIAL: HEADER GLASS FILLED POLYESTER, 94V-0, MOLDED BLACK
 - THIS PART CONFORMS TO PRODUCT SPEC PS-08-50
 - PARTS ARE STACKABLE END TO END ON .156 CENTERS. (SPACING TABS MUST BE REMOVED ON CIRCUIT SIZES 1 THROUGH 23 BEFORE PARTS ARE STACKABLE.)

PLATINGS: PIN MATERIAL: BRASS
 (102) TIN .000200 MIN. OVER COPPER.
 (501) GOLD .000020 MIN. OVER NICKEL
 (503) GOLD .000030 MIN. OVER NICKEL
 FOR ADDITIONAL INFORMATION SEE SDES-88.

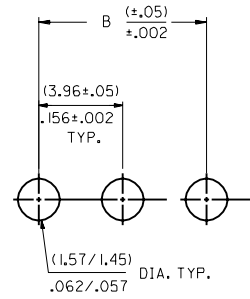

PCB LAYOUT: COMPONENT SIDE
 RECOMMENDED PCB THICKNESS:
 (1.57±.18) / .062±.007

A-41711-N* * * *
 PACKAGING AND OPTIONS }
 NO. OF CKTS }
 PIN DIMENSIONS }
 VOID LOCATIONS
 BLANK=NO VOIDS
 MULT. VOIDS START WITH 51
 NO.=CKT. NO. VOIDED
 PLATING

B	A	CIRCUIT
(3.96)	(6.78 / 7.87)	2
.156	.267 / .310	
(7.92)	(10.74 / 11.84)	3
.312	.423 / .466	
(11.89)	(14.71 / 15.80)	4
.468	.579 / .622	
(15.85)	(18.67 / 19.76)	5
.624	.735 / .778	
(19.81)	(22.63 / 23.72)	6
.780	.891 / .934	
(23.77)	(26.59 / 27.69)	7
.936	1.047 / 1.090	
(27.74)	(30.56 / 31.65)	8
1.092	1.203 / 1.246	
(31.70)	(34.52 / 35.61)	9
1.248	1.359 / 1.402	
(35.66)	(38.48 / 39.57)	10
1.404	1.515 / 1.558	
(39.62)	(42.44 / 43.54)	11
1.560	1.671 / 1.714	
(43.59)	(46.41 / 47.50)	12
1.716	1.827 / 1.870	
(47.55)	(50.37 / 51.46)	13
1.872	1.983 / 2.026	
(51.51)	(54.33 / 55.42)	14
2.028	2.139 / 2.182	
(55.47)	(58.29 / 59.39)	15
2.184	2.295 / 2.338	
(59.44)	(62.26 / 63.35)	16
2.340	2.451 / 2.494	
(63.40)	(66.22 / 67.31)	17
2.496	2.607 / 2.650	
(67.36)	(70.18 / 71.27)	18
2.652	2.763 / 2.806	
(71.32)	(74.14 / 75.23)	19
2.808	2.919 / 2.962	
(75.29)	(78.11 / 79.20)	20
2.964	3.075 / 3.118	
(79.25)	(82.07 / 83.16)	21
3.120	3.231 / 3.274	
(83.21)	(86.03 / 87.12)	22
3.276	3.387 / 3.430	
(87.17)	(89.94 / 91.08)	23
3.432	3.541 / 3.586	
(91.14)	(93.85 / 95.00)	24
3.588	3.695 / 3.740	

5	H9
4	H9
3	H12
2	H5
1	J

DIMENSIONS SHOWN METRIC () INCH		UNLESS OTHERWISE SPECIFIED TOLERANCES: ANGULAR ± 1°		REVISIONS ONLY ON CAD SYSTEM	
3 PLACE ± .010	INCH	METRIC	TITLE		
2 PLACE ± .014 ± 0.25	BREAKAWAY HEADER ASSEMBLY				
1 PLACE ± 0.36	FR. LK. STRAIGHT ROUND PINS				
DRAFT WHERE APPLICABLE MUST REMAIN WITHIN DIMENSIONS					41711 SERIES DWG.
DRWG. BY: SAMIEC	CHKD. BY: PATEL	MOLEX INCORPORATED		SHEET NO. 1	DATE 08/19/85
APP'D. LENZ	SCALE: 1:1	LISE, LILL, 60532 U.S.A.		SDA-41711	
LTR.	REVISIONS	LTR.	REVISIONS	FILE NAME: S41711X1	THIS DRAWING CONTAINS INFORMATION THAT IS PROPRIETARY TO MOLEX INC. AND SHOULD NOT BE USED WITHOUT WRITTEN PERMISSION.

	13	12	11	10	9	8	7	6	41711	4	3	2	1	
J	ENG. NO.	PIN NO.	DIM. L	DIM. X	DIM. Z	EDPS ON SHT./COL.								J
	A-41711-ANA102-*	2173-K102)	(19.05) .750	(11.43) .450	(4.37) .172	3 / 1								
	A-41711-ANA501-*	2173-K501)	(19.05) .750	(11.43) .450	(4.37) .172	3 / 3								
I						/								I
						/								
						/								
H						/								H
						/								
						/								
G						/								G
						/								
						/								
F						/								F
						/								
						/								
E						/								E
						/								
						/								
D						/								D
						/								
						/								
C						/								C
						/								
						/								
B						/								B
						/								
						/								
A						/								A

41711

SEE SHEET I	H2	SEE SHEET I	DIMENSIONS SHOWN (METRIC) INCH	REVISIONS	LTR.	REVISIONS	DRWG. NO.	SDA-41711
SEE SHEET I	E1	SEE SHEET I	UNLESS OTHERWISE SPECIFIED TOLERANCES ANGULAR ± 1/2°	SEE SHEET I		SEE SHEET I	FILE NAME	S41711X2
SEE SHEET I	E	SEE SHEET I	INCH METRIC	SEE SHEET I		SEE SHEET I	THIS DRAWING CONTAINS INFORMATION THAT IS PROPRIETARY TO MOLEX INC. AND SHOULD NOT BE USED WITHOUT WRITTEN PERMISSION	DIN. SIZE KK C
SEE SHEET I	D	SEE SHEET I	3 PLACE ±	SEE SHEET I		SEE SHEET I	MOLEX INCORPORATED	60532
SEE SHEET I	A	SEE SHEET I	2 PLACE ±	SEE SHEET I		SEE SHEET I	U.S.A.	2
SEE SHEET I	2	SEE SHEET I	1 PLACE ±	SEE SHEET I		SEE SHEET I	DATE	08/19/85
H5	SEE SHEET I	1	SEE SHEET I	SEE SHEET I		SEE SHEET I	MOLEX INCORPORATED	60532
LTR.	REVISIONS	LTR.	REVISIONS	DRWG. BY	SAMIEC	CHK'D. BY	PAI TEL	
				APP'D. BY	LENZ	SCALE		

A-41711-ANA102-*			A-41711-ANA102-*			A-41711-ANA501-*					
PART NO.	ENG. NO(SUFFIX ONLY)	VOID CKT.	PART NO.	ENG. NO(SUFFIX ONLY)	VOID CKT.	PART NO.	ENG. NO(SUFFIX ONLY)	VOID CKT.	PART NO.	ENG. NO(SUFFIX ONLY)	VOID CKT.
26-51-0022	-A2A102		26-51-1061	-A6A102-51	5,6	26-51-2022	-A2A501				
26-51-0032	-A3A102		26-51-1085	-A8A102-52	1,6	26-51-2032	-A3A501				
26-51-0042	-A4A102		26-51-1106	-A10A102-53	9,10	26-51-2042	-A4A501				
26-51-0052	-A5A102		26-51-1122	-A12A102-52	3,5,9,11	26-51-2052	-A5A501				
26-51-0062	-A6A102		26-51-1188	-A18A102-56	11,12	26-51-2062	-A6A501				
26-51-0072	-A7A102		26-51-1189	-A18A102-58	10,15,16,17	26-51-2072	-A7A501				
26-51-0082	-A8A102		26-51-1201	-A20A102-6	6	26-51-2082	-A8A501				
26-51-0092	-A9A102		26-51-1202	-A20A102-14	14	26-51-2092	-A9A501				
26-51-0102	-A10A102		26-51-1052	-A5A102-2	2	26-51-2102	-A10A501				
26-51-0112	-A11A102		26-51-1041	-A4A102-2	2	26-51-2112	-A11A501				
26-51-0122	-A12A102		26-51-1107	-A10A102-54	3,4	26-51-2122	-A12A501				
26-51-0132	-A13A102		26-51-1088	-A8A102-54	2,4	26-51-2132	-A13A501				
26-51-0142	-A14A102		26-51-1071	-A7A102-2	2	26-51-2142	-A14A501				
26-51-0152	-A15A102		26-51-1042	-A4A102-51	2,3	26-51-2152	-A15A501				
26-51-0162	-A16A102		26-51-1089	-A8A102-2	2	26-51-2162	-A16A501				
26-51-0172	-A17A102					26-51-2172	-A17A501				
26-51-0182	-A18A102					26-51-2182	-A18A501				
26-51-0192	-A19A102					26-51-2192	-A19A501				
26-51-0202	-A20A102					26-51-2202	-A20A501				
26-51-0212	-A21A102					26-51-2212	-A21A501				
26-51-0222	-A22A102					26-51-2222	-A22A501				
26-51-0232	-A23A102					26-51-2232	-A23A501				
26-51-0242	-A24A102					26-51-2242	-A24A501				
26-51-1181	-A18A102-55	6,8,10,12,15,17									
26-51-1141	-A14A102-6	6									
26-51-1182	-A18A102-51	7,9,10,12,14,16									
26-51-1183	-A18A102-10	10									
26-51-1184	-A18A102-6	6									
26-51-1142	-A14A102-11	11									
26-51-1105	-A10A102-4	4									
26-51-1121	-A12A102-4	4									
26-51-1151	-A15A102-9	9									
26-51-1101	-A10A102-51	2,4,6,8									
26-51-1185	-A18A102-54	4,11,14									
26-51-1081	-A8A102-53	3,6,7									
26-51-1102	-A10A102-52	2,4,8,10									
	-A11A102-2	2									
26-51-1103	-A10A102-9	9									
26-51-1031	-A3A102-2	2									
26-51-1104	-A10A102-5	5									
26-51-1082	-A8A102-7	7									
26-51-1083	-A8A102-5	5									
26-51-1051	-A5A102-51	2,4									
26-51-1186	-A18A102-53	6,8,10,12,14,16									
26-51-1062	-A6A102-5	5									
26-51-1086	-A8A102-8	8									
26-51-1087	-A8A102-51	1,6,7,8									
26-51-1123	-A12A102-51	2,4,9,11									
26-51-1187	-A18A102-52	10,17									
26-51-1180	-A18A102-57	10,12									
26-51-1084	-A8A102-6	6									
COLUMN NO. 1			COLUMN NO. 2			COLUMN NO. 3			COLUMN NO. 4		
CON'T. IN COLUMN NO. 2 SHEET NO. 3			CON'T. IN COLUMN NO. 2 SHEET NO. 3			CON'T. IN COLUMN NO. 3 SHEET NO. 3			CON'T. IN COLUMN NO. 4 SHEET NO. 3		
			SEE SHEET I H11 SEE SHEET I			SEE SHEET I H10 SEE SHEET I			SEE SHEET I H7 SEE SHEET I		
			SEE SHEET I H6 SEE SHEET I			SEE SHEET I H5 SEE SHEET I			SEE SHEET I H4 SEE SHEET I		
			SEE SHEET I H3 SEE SHEET I			SEE SHEET I H2 SEE SHEET I			SEE SHEET I H1 SEE SHEET I		
			LTR. REVISIONS			LTR. REVISIONS			LTR. REVISIONS		

41711

41711

DIMENSIONS SHOWN (METRIC) INCH
 UNLESS OTHERWISE SPECIFIED
 TOLERANCES ANGULAR ± 1/2°
 INCH METRIC
 3 PLACE ± ±
 2 PLACE ± ±
 1 PLACE ± ±
 DRAFT WHERE APPLICABLE MUST
 REMAIN WITHIN DIMENSIONS
 DRWG. BY: SAMIEC CHK'D. BY: PATEL
 APP'D. BY: LENZ SCALE: 1:1
 FILE NAME: S41711X3 THIS DRAWING CONTAINS INFORMATION THAT IS PROPRIETARY TO MOLEX INC. AND SHOULD NOT BE USED WITHOUT WRITTEN PERMISSION.

REVISE ONLY ON CAD SYSTEM
 TITLE: BREAKAWAY HEADER ASSEMBLY FR. LK. STRAIGHT ROUND PINS 41711 SERIES DWG.
 MOLEX INCORPORATED U.S.A. SHEET NO. 3 DATE 08/19/85
 PART NO. SDA-41711
 SEE CHART
 DRWG. NO. SDA-41711
 DIV. KK SIZE C