

3S1-Series
Sub-Miniature
Pushbutton Switch

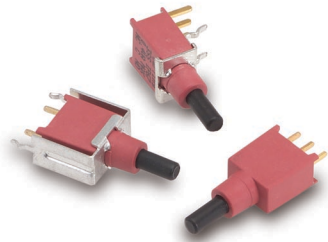

3SS-Series
Sealed Sub-Miniature
Pushbutton Switch

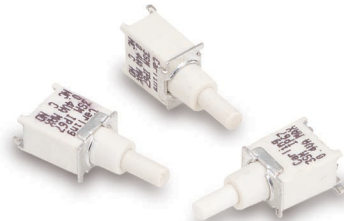

3SM-Series
Sealed Surface
Mount Sub-Miniature
Pushbutton Switch

Specifications

Contact Rating refer to ordering scheme
 Electrical Life 50,000 make & break cycles @ full load
 Contact Resistance. 20 mΩ max. initial @ 2-4 VDC
 100mA for both silver & gold plated contacts.
 Insulation Resistance 1000 MΩ min.
 Dielectric Strength 1500 Volts RMS @ sea level
 Operating Temperature -30°C to +85°C
 Index of Protection **3SS & 3SM-Series:** IP67
 Solder Heat Resistance. MIL-STD-202, Method 210
 Actuator Travel 25°

Materials

Case UL 94-0
3S1-Series: Diallyl phthalate (DAP)
3SS-Series: Glass filled nylon 6/6, flame retardant, heat stabilized
3SM-Series: Glass filled nylon 4/6, flame retardant, heat stabilized
 Plunger. *3S1-Series:* Thermoplastic polyester, black
3SS-Series: Thermoplastic polyester (UL 94V-0), with internal o-ring seal
3SM-Series: Glass filled nylon 4/6, flame retardant, heat stabilized
 Bushing *3S1-Series:* Brass, nickel plated
3SS-Series: Glass filled nylon 6/6, flame retardant, heat stabilized (UL 94V-0)
3SM-Series: Glass filled nylon 4/6, flame retardant, heat stabilized (UL 94V-0)
 Housing. Stainless Steel
 Switch Support Brass, tin plated
 Terminal Seal Epoxy

3S1-Series Ordering Scheme



1 SERIES 3S1 Sub-Miniature Pushbutton Switch												
2 POLES SP single pole												
3 CIRCUIT () - momentary <table style="width: 100%; border-collapse: collapse;"> <tr> <td style="width: 30%;">8</td> <td style="width: 30%;">ON</td> <td style="width: 40%;">(ON)</td> </tr> <tr> <td>9</td> <td>OFF</td> <td>(OFF)</td> </tr> </table>	8	ON	(ON)	9	OFF	(OFF)						
8	ON	(ON)										
9	OFF	(OFF)										
4 BUSHING <table style="width: 100%; border-collapse: collapse;"> <tr><td>B5</td><td>10-48 Threaded</td></tr> <tr><td>B6</td><td>Unthreaded "D"</td></tr> <tr><td>B7</td><td>Unthreaded</td></tr> <tr><td>B8</td><td>1/4-40 Threaded "D"</td></tr> <tr><td>B9</td><td>Flush Bushing</td></tr> <tr><td>B0</td><td>1/4" Unthreaded "D"</td></tr> </table>	B5	10-48 Threaded	B6	Unthreaded "D"	B7	Unthreaded	B8	1/4-40 Threaded "D"	B9	Flush Bushing	B0	1/4" Unthreaded "D"
B5	10-48 Threaded											
B6	Unthreaded "D"											
B7	Unthreaded											
B8	1/4-40 Threaded "D"											
B9	Flush Bushing											
B0	1/4" Unthreaded "D"											

5 TERMINATION		
M1	Solder Lug	
M2	PCB	
M6	PC Mount, 90° horizontal	
M61	Snap-In, 90° horizontal	
M7	PC Mount, 90° vertical	
M71	Snap-In, 90° vertical	
VS2	PC Mount, U bracket, .620 mounting x .460 high	
VS21	Snap-In, U bracket	

6 CONTACT		
	<i>Material</i>	<i>Terminal Plating</i>
G	silver ¹	gold over silver ³
K	gold ²	tin-lead ⁴
P	silver ¹	tin-lead ⁴
Q	silver ¹	silver ¹
R	gold ²	gold ²
		<i>Rating</i>
		1A @ 125VAC or 28VDC
		0.4VA max. @ 20V max (AC/DC)
		1A @ 125VAC or 28VDC
		1A @ 125VAC or 28VDC
		0.4VA max. @ 20V max (AC/DC)

NOTE:
 Tin-lead option available with PC type terminations only.
 1 Moveable contact & terminals: copper alloy, silver plate
 2 Moveable contact & terminals: copper alloy with gold plate over nickel plate
 3 Terminals: silver plated with outer layer in gold plating
 4 Outer terminals: copper alloy with tin-lead over nickel plate

7 EPOXY SEAL	
E	epoxy seal

3SS-Series Ordering Scheme

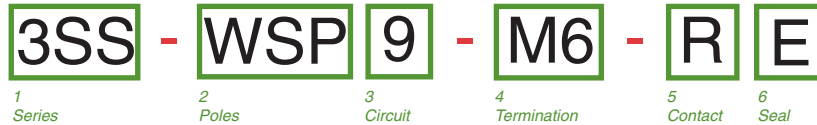

1 SERIES 3SS Sealed Sub-Miniature Pushbutton Switch														
2 POLES WSP single pole WDP double pole														
3 CIRCUIT () - momentary <table style="width: 100%; border-collapse: collapse;"> <tr> <td style="width: 10%;">8</td> <td style="width: 40%;">ON</td> <td style="width: 10%;"></td> <td style="width: 10%;">(ON)</td> </tr> <tr> <td>9</td> <td>OFF</td> <td></td> <td>(ON)</td> </tr> </table>	8	ON		(ON)	9	OFF		(ON)						
8	ON		(ON)											
9	OFF		(ON)											
4 TERMINATION <table style="width: 100%; border-collapse: collapse;"> <tr><td>M2</td><td>PCB</td></tr> <tr><td>M6</td><td>PC Mount, 90° horizontal</td></tr> <tr><td>M61</td><td>Snap-In, 90° horizontal</td></tr> <tr><td>M7</td><td>PC Mount, 90° vertical</td></tr> <tr><td>M71</td><td>Snap-In, 90° vertical</td></tr> <tr><td>VS2</td><td>PC Mount, U bracket</td></tr> <tr><td>VS21</td><td>Snap-In, U bracket</td></tr> </table>	M2	PCB	M6	PC Mount, 90° horizontal	M61	Snap-In, 90° horizontal	M7	PC Mount, 90° vertical	M71	Snap-In, 90° vertical	VS2	PC Mount, U bracket	VS21	Snap-In, U bracket
M2	PCB													
M6	PC Mount, 90° horizontal													
M61	Snap-In, 90° horizontal													
M7	PC Mount, 90° vertical													
M71	Snap-In, 90° vertical													
VS2	PC Mount, U bracket													
VS21	Snap-In, U bracket													

5 CONTACT <table style="width: 100%; border-collapse: collapse;"> <thead> <tr> <th style="text-align: left; font-weight: normal;">Material</th> <th style="text-align: left; font-weight: normal;">Terminal Plating</th> <th style="text-align: left; font-weight: normal;">Rating</th> <th style="text-align: left; font-weight: normal;"></th> </tr> </thead> <tbody> <tr> <td>G silver¹</td> <td>gold over silver³</td> <td>1A@125VAC or 28VDC</td> <td>IP67</td> </tr> <tr> <td>K gold²</td> <td>tin-lead⁴</td> <td>0.4VA max. @20V max (AC/DC)</td> <td>IP67</td> </tr> <tr> <td>P silver¹</td> <td>tin-lead⁴</td> <td>1A@125VAC or 28VDC</td> <td>IP67</td> </tr> <tr> <td>R gold²</td> <td>gold²</td> <td>0.4VA max. @20V max (AC/DC)</td> <td>IP67</td> </tr> </tbody> </table> <p style="font-size: x-small; margin-top: 5px;">NOTE: Tin-lead option available with PC type terminations only.</p> <ol style="list-style-type: none"> 1 Moveable contact & terminals: copper alloy, silver plate 2 Moveable contact & terminals: copper alloy with gold plate over nickel plate 3 Terminals: silver plate with outer layer in gold plating 4 Outer terminals: copper alloy with tin-lead over nickel plate 	Material	Terminal Plating	Rating		G silver ¹	gold over silver ³	1A@125VAC or 28VDC	IP67	K gold ²	tin-lead ⁴	0.4VA max. @20V max (AC/DC)	IP67	P silver ¹	tin-lead ⁴	1A@125VAC or 28VDC	IP67	R gold ²	gold ²	0.4VA max. @20V max (AC/DC)	IP67
Material	Terminal Plating	Rating																		
G silver ¹	gold over silver ³	1A@125VAC or 28VDC	IP67																	
K gold ²	tin-lead ⁴	0.4VA max. @20V max (AC/DC)	IP67																	
P silver ¹	tin-lead ⁴	1A@125VAC or 28VDC	IP67																	
R gold ²	gold ²	0.4VA max. @20V max (AC/DC)	IP67																	
6 EPOXY SEAL E epoxy seal																				

3SM-Series Ordering Scheme



1 SERIES 3SM Sealed Surface Mount Pushbutton Switch								
2 POLES SP single pole DP double pole								
3 CIRCUIT () - momentary <table style="width: 100%; border-collapse: collapse;"> <tr> <td style="width: 10%;">8</td> <td style="width: 40%;">ON</td> <td style="width: 10%;"></td> <td style="width: 10%;">(ON)</td> </tr> <tr> <td>9</td> <td>OFF</td> <td></td> <td>(ON)</td> </tr> </table>	8	ON		(ON)	9	OFF		(ON)
8	ON		(ON)					
9	OFF		(ON)					
4 TERMINATION <table style="width: 100%; border-collapse: collapse;"> <tr><td>M6</td><td>Surface Mount, 90° flat</td></tr> <tr><td>M7</td><td>Surface Mount, 90° vertical</td></tr> <tr><td>S6</td><td>Surface Mount, 90° horizontal</td></tr> </table>	M6	Surface Mount, 90° flat	M7	Surface Mount, 90° vertical	S6	Surface Mount, 90° horizontal		
M6	Surface Mount, 90° flat							
M7	Surface Mount, 90° vertical							
S6	Surface Mount, 90° horizontal							

5 CONTACT <table style="width: 100%; border-collapse: collapse;"> <thead> <tr> <th style="text-align: left; font-weight: normal;">Material</th> <th style="text-align: left; font-weight: normal;">Terminal Plating</th> <th style="text-align: left; font-weight: normal;">Rating</th> <th style="text-align: left; font-weight: normal;"></th> </tr> </thead> <tbody> <tr> <td>G silver¹</td> <td>gold over silver³</td> <td>1A@125VAC or 28VDC</td> <td>IP67</td> </tr> <tr> <td>K gold²</td> <td>tin-lead plated⁴</td> <td>0.4VA max. @20V max (AC/DC)</td> <td>IP67</td> </tr> <tr> <td>P silver¹</td> <td>tin-lead plated⁴</td> <td>1A@125VAC or 28VDC</td> <td>IP67</td> </tr> <tr> <td>R gold²</td> <td>gold plated²</td> <td>0.4VA max. @20V max (AC/DC)</td> <td>IP67</td> </tr> </tbody> </table> <p style="font-size: x-small; margin-top: 5px;">NOTE: Tin-lead option available with PC type terminations only.</p> <ol style="list-style-type: none"> 1 Moveable contact & terminals: copper alloy, silver plate 2 Moveable contact & terminals: copper alloy with gold plate over nickel plate 3 Terminals: silver plate with outer layer in gold plating 4 Outer terminals: copper alloy with tin-lead over nickel plate 	Material	Terminal Plating	Rating		G silver ¹	gold over silver ³	1A@125VAC or 28VDC	IP67	K gold ²	tin-lead plated ⁴	0.4VA max. @20V max (AC/DC)	IP67	P silver ¹	tin-lead plated ⁴	1A@125VAC or 28VDC	IP67	R gold ²	gold plated ²	0.4VA max. @20V max (AC/DC)	IP67
Material	Terminal Plating	Rating																		
G silver ¹	gold over silver ³	1A@125VAC or 28VDC	IP67																	
K gold ²	tin-lead plated ⁴	0.4VA max. @20V max (AC/DC)	IP67																	
P silver ¹	tin-lead plated ⁴	1A@125VAC or 28VDC	IP67																	
R gold ²	gold plated ²	0.4VA max. @20V max (AC/DC)	IP67																	
6 EPOXY SEAL E epoxy seal																				
7 PACKAGING Switches are bulk packed, unless T/R is specified at the end of the part number. T/R tape reel - 500 pieces per reel																				

3S-Series Optional Cap

To order accessories assembled on a switch, specify the switch number followed by the accessory part number and the word "assembled".

Ex: 3S1-SP9-B6-M7-RE-C23ASSEMBLED

To order accessories in bulk, specify the Series, followed by the accessory. Ex.) 3S1-C13

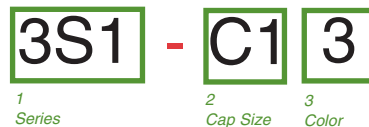

1 SERIES OR SWITCH CATALOG NUMBER 3S1, 3SS or 3SM		
2 CAP SIZE <table style="width: 100%; border-collapse: collapse;"> <tr> <td style="width: 50%;">C1 10.6mm</td> <td style="width: 50%;">C2 7.6mm</td> </tr> </table>	C1 10.6mm	C2 7.6mm
C1 10.6mm	C2 7.6mm	

3 CAP COLOR¹ <table style="width: 100%; border-collapse: collapse;"> <tr> <td style="width: 50%;">1 white</td> <td style="width: 50%;">5 yellow</td> </tr> <tr> <td>2 black</td> <td>6 green</td> </tr> <tr> <td>3 red</td> <td>7 blue</td> </tr> <tr> <td>4 orange</td> <td></td> </tr> </table>	1 white	5 yellow	2 black	6 green	3 red	7 blue	4 orange	
1 white	5 yellow							
2 black	6 green							
3 red	7 blue							
4 orange								
¹ Black, white & red standard. Other colors available. Consult factory.								

3S1-Series Dimensional Specifications: in. [mm]

ACTUATOR

OP1

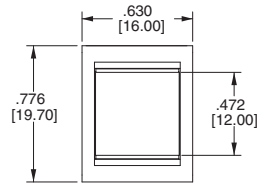
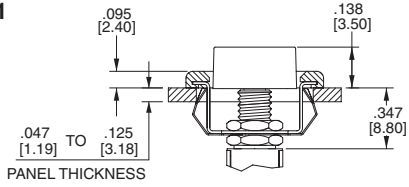

PANEL MOUNTING

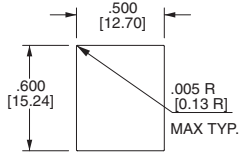

CAP

C1

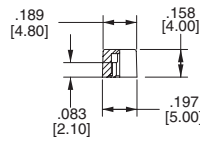

C2

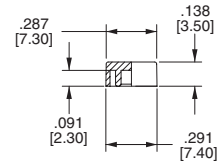

BUSHING

B5

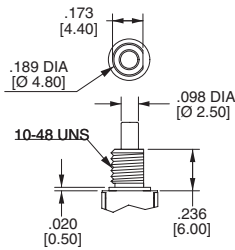

B6

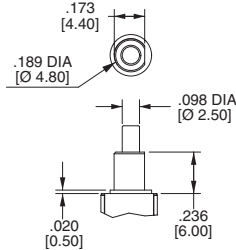

B7

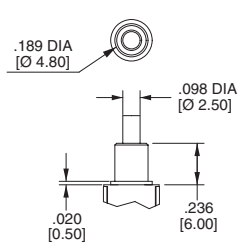

B8

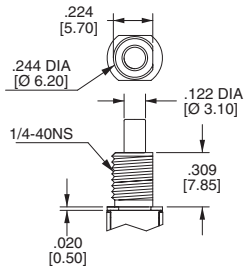

B9

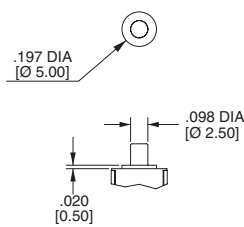

B0

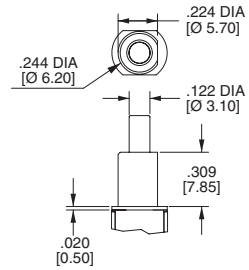

TERMINATION

SP8

SINGLE POLE DOUBLE THROW

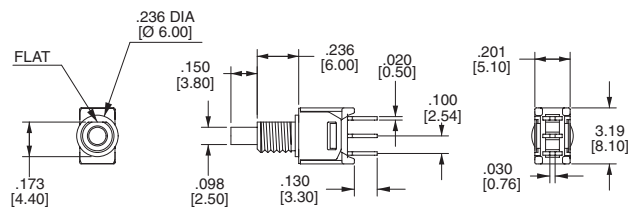

SP9

SINGLE POLE SINGLE THROW

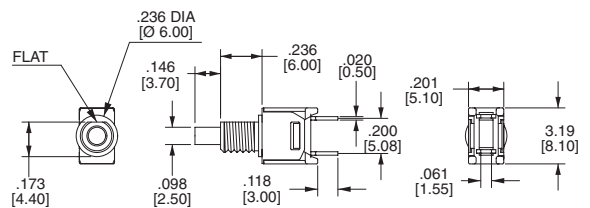

3S1-Series Dimensional Specifications: in. [mm]

TERMINATION

M1

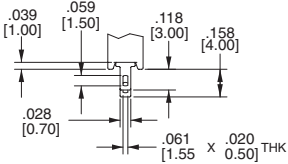

M2

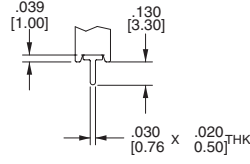

VS2

SINGLE POLE DOUBLE THROW

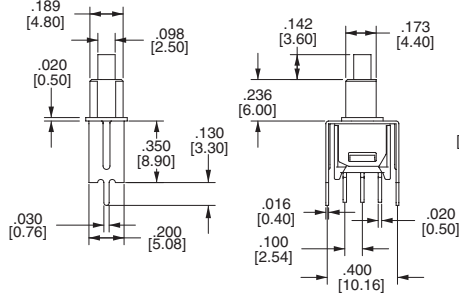

PC MOUNTING

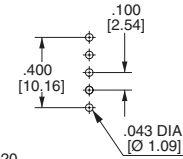

VS2

SINGLE POLE, SINGLE THROW

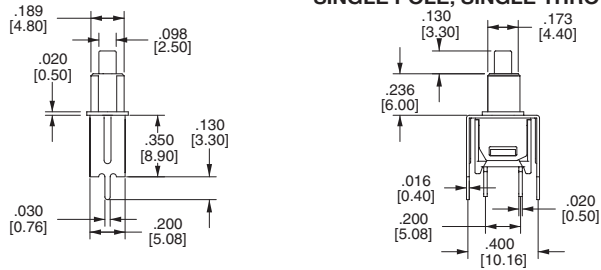

PC MOUNTING

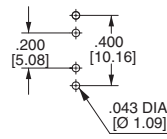

M6

SINGLE POLE, SINGLE THROW

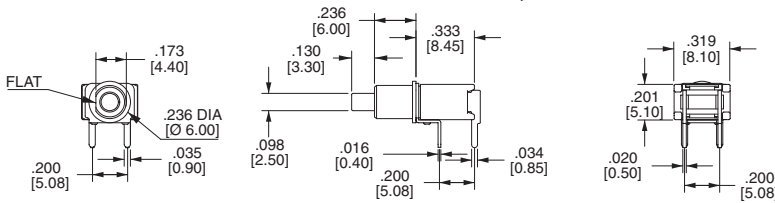

PC MOUNTING

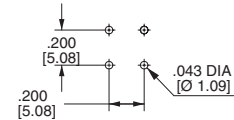

SINGLE POLE, DOUBLE THROW

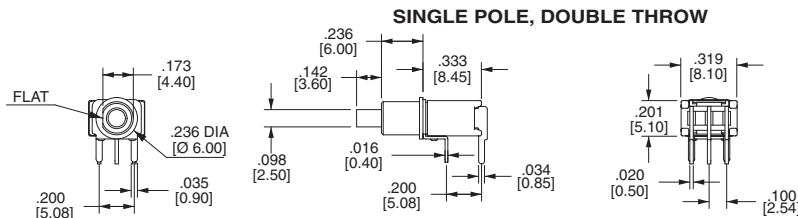

PC MOUNTING

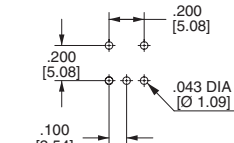

M7

SINGLE POLE, SINGLE THROW

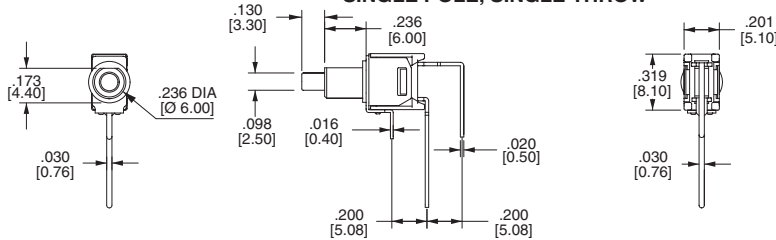

PC MOUNTING

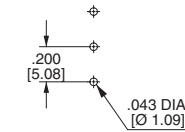

SINGLE POLE, DOUBLE THROW

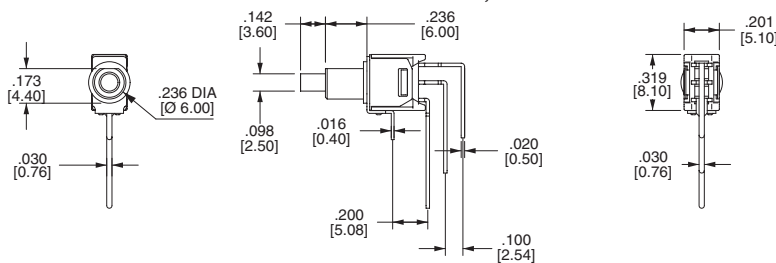

PC MOUNTING

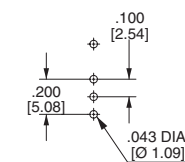

3SS-Series Dimensional Specifications: in. [mm]

SNAP-IN TERMINATION

M61

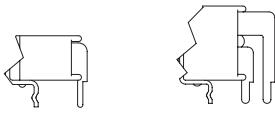

M71

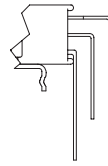

VS21

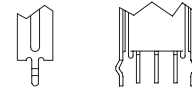

M61, M71, VS21 have the same P.C. mounting but with snap-in bracket.

TERMINATION

SINGLE POLE, SINGLE THROW

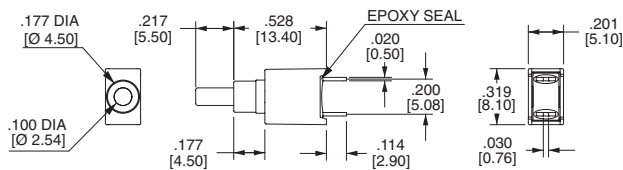

SINGLE POLE, DOUBLE THROW

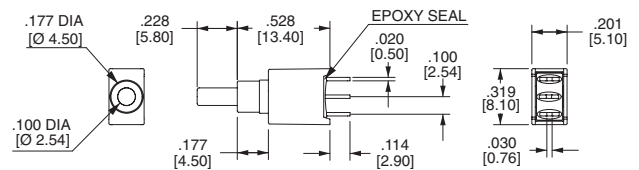

DOUBLE POLE, SINGLE THROW

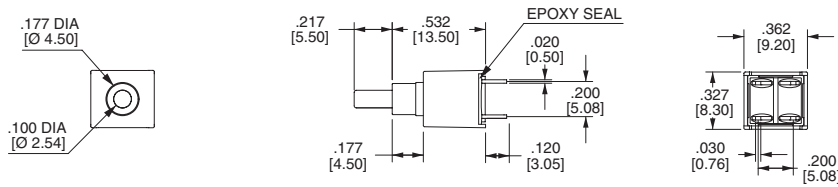

M6

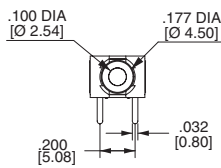

SINGLE POLE, SINGLE THROW

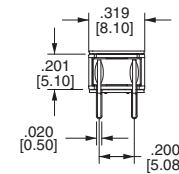
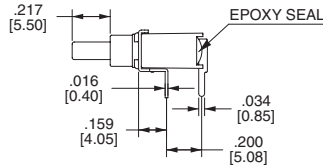

PC MOUNTING

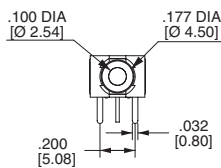
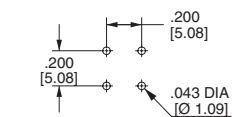

SINGLE POLE, DOUBLE THROW

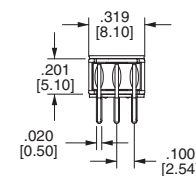
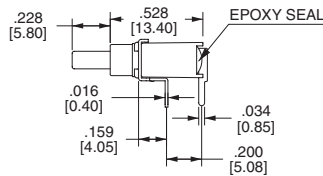

PC MOUNTING

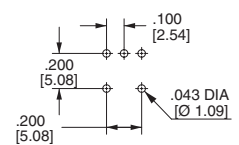

DOUBLE POLE, SINGLE THROW

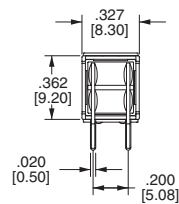
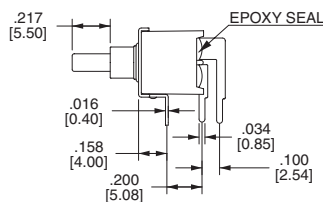
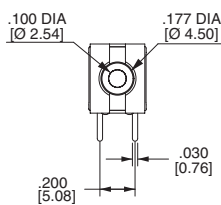

PC MOUNTING

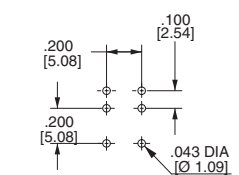

3SS-Series Dimensional Specifications: in. [mm]

TERMINATION

M7

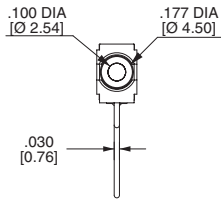

SINGLE POLE, SINGLE THROW

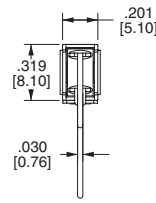
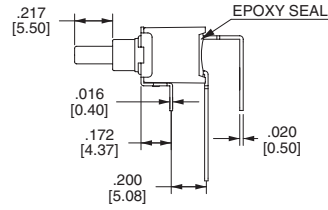

PC MOUNTING

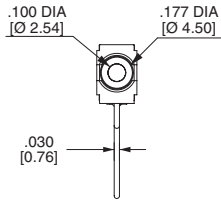
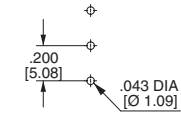

SINGLE POLE, DOUBLE THROW

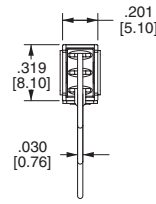
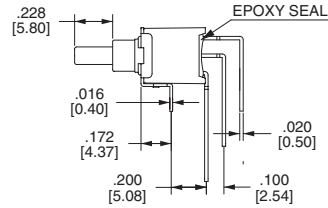

PC MOUNTING

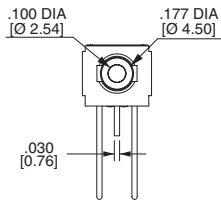
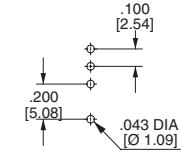

DOUBLE POLE, SINGLE THROW

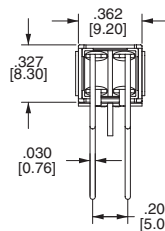
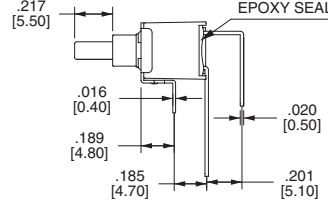

PC MOUNTING

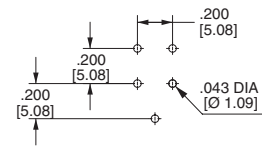

VS2

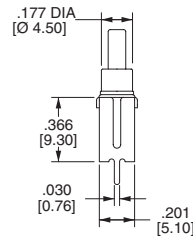

SINGLE POLE, SINGLE THROW

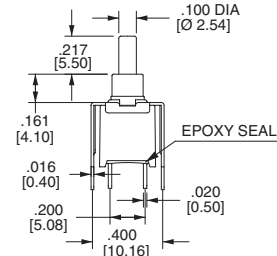

PC MOUNTING

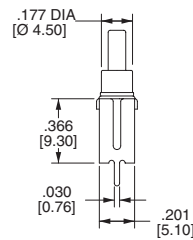
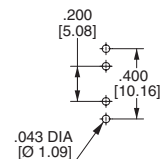

SINGLE POLE, DOUBLE THROW

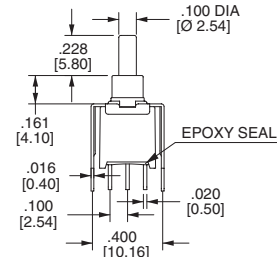

PC MOUNTING

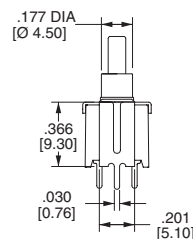
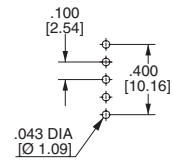

DOUBLE POLE, SINGLE THROW

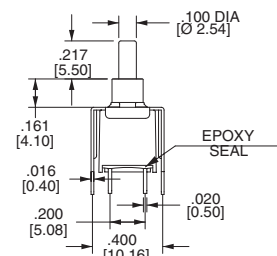

PC MOUNTING

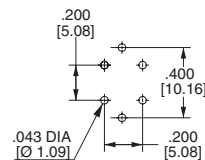

3SM-Series Dimensional Specifications: in. [mm]

TERMINATION

M6

SINGLE THROW

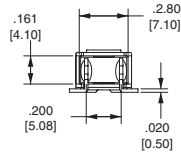
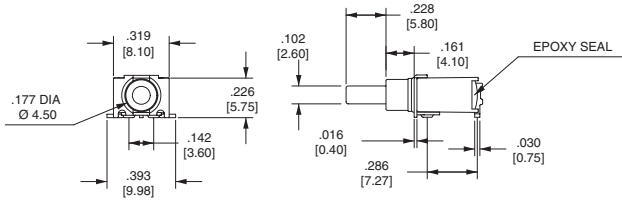

PC MOUNTING

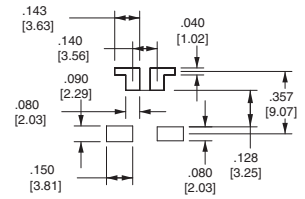

DOUBLE THROW

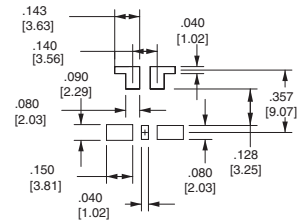
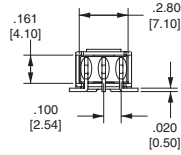
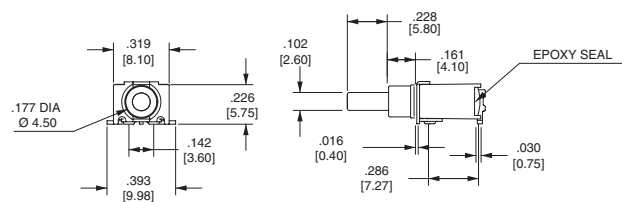

M7

SINGLE THROW

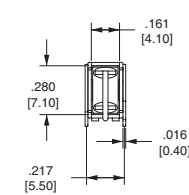
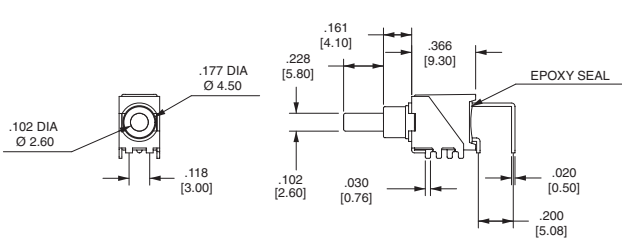

PC MOUNTING

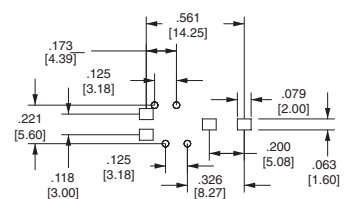

DOUBLE THROW

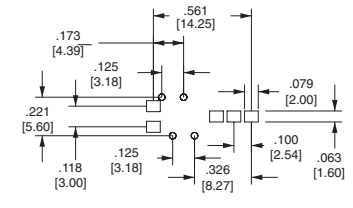
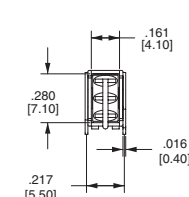
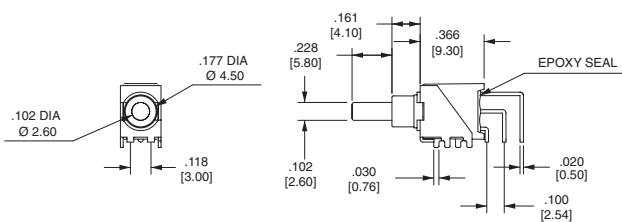

S6

SINGLE THROW

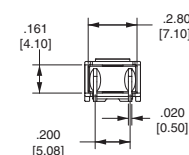
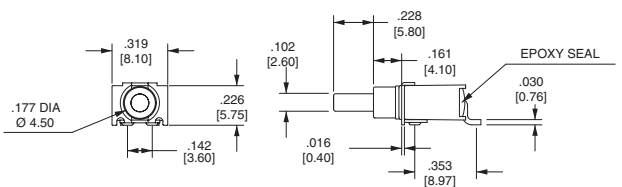

PC MOUNTING

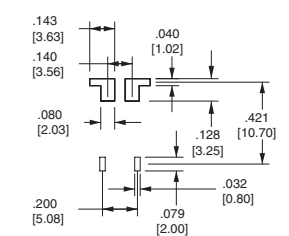

DOUBLE THROW

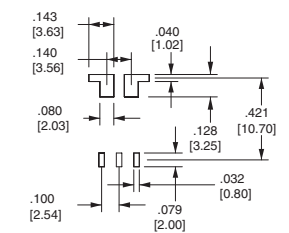
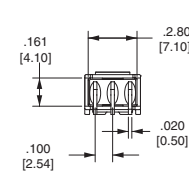
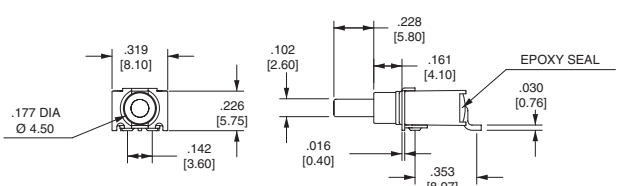

3SM-Series Dimensional Specifications: in. [mm]

SNAP-IN TERMINATION

M61

M71

VS21

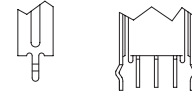
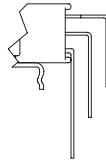
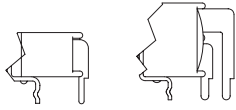

M61, M71, VS21 have the same P.C. mounting but with snap-in bracket.

REEL TAPING

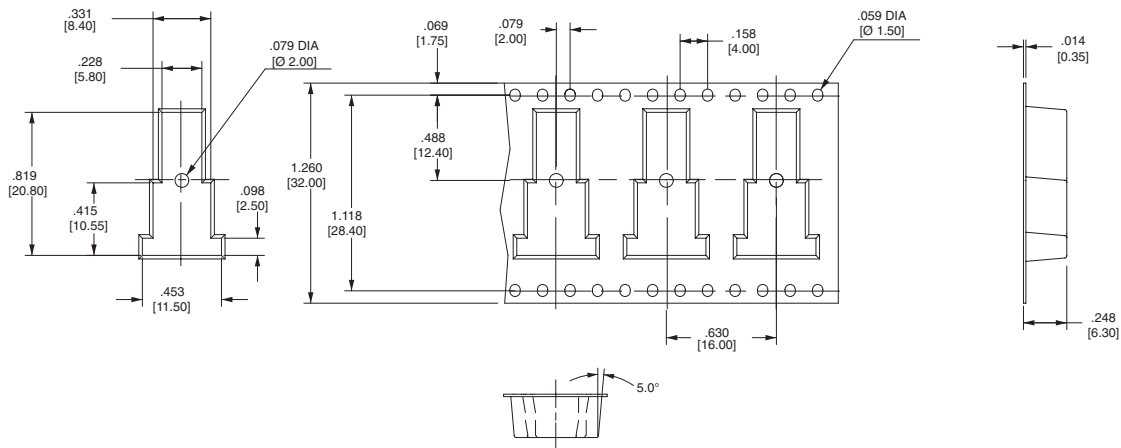

FOR M6 ONLY