

## Core **ER40/22/13**

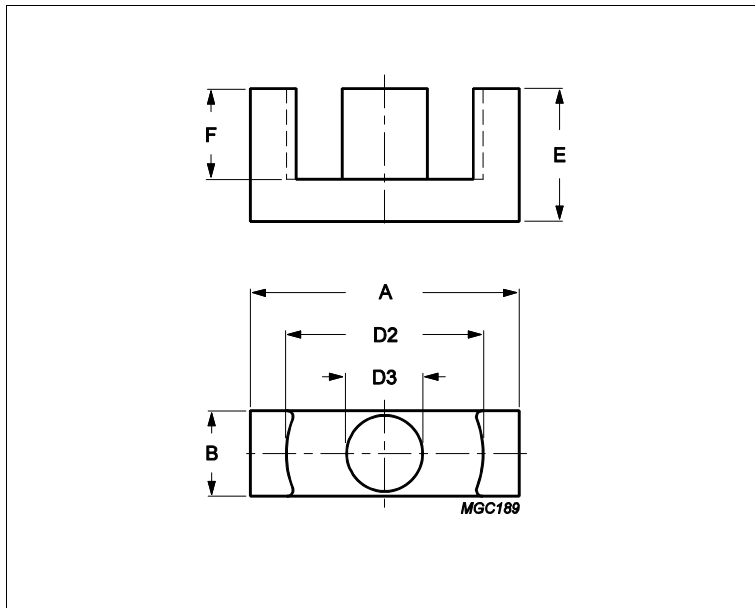

Effective parameters			
	Parameter	Value	Unit
$\Sigma(I/A)$	core factor (C1)	0.658	mm <sup>-1</sup>
<b>Ve</b>	effective volume	14600	mm <sup>3</sup>
<b>Le</b>	effective length	98	mm
<b>Ae</b>	effective area	149	mm <sup>2</sup>
<b>Amin</b>	minimum area	139	mm <sup>2</sup>
<b>m</b>	ER40/22/13	≈ 37	g/pcs

Dimensions for product: ER40/22/13						
	Nom	Tol +	Tol -	Max	Min	Unit
<b>A</b>	40.00	0.70	0.70	40.70	39.30	mm
<b>B</b>	13.40	0.35	0.35	13.75	13.05	mm
<b>D2</b>	29.60	0.60	0.60	30.20	29.00	mm
<b>D3</b>	13.30	0.25	0.25	13.55	13.05	mm
<b>E</b>	22.40	0.20	0.20	22.60	22.20	mm
<b>F</b>	15.45	0.35	0.35	15.80	15.10	mm

Inductance factor				
Material	Value	Tol +	Tol -	Unit
3C94	3600	25%	25%	nH/turns <sup>2</sup>

Power loss: 3C94				
Measuring conditions			Max	Unit
100 kHz	200 mT	100 °C	7.300	W/set

Bsat					
Measuring conditions			Material	Min	Unit
25 kHz	250 A/m	100 °C	3C94	320	mT